

THE SHORES

FOR LEASE

3150 Lexington Ave N | Shoreview MN | 55126



1,436-2,344 SF of Retail Available

Blake Martin

612.465.8521

blake@upland.com

Rob Kost, CCIM

612.465.8530

rob@upland.com

UPLAND
REAL ESTATE GROUP, INC.

sherman
ASSOCIATES

PROPERTY OVERVIEW

PROPERTY INFORMATION

ADDRESS	3150 Lexington Ave N
CITY, STATE	Shoreview, MN
SPACE AVAILABLE	1,346 end cap next to parking lot 2,344 SF (Former Salon)
LEASE RATE	\$6.00-\$10.00
CAM & TAX 2017	\$9.50 PSF
UTILITIES	Tenant Pays Separately
COUNTY	Ramsey
PARKING	Surface parking for customers and garage parking for tenant staff

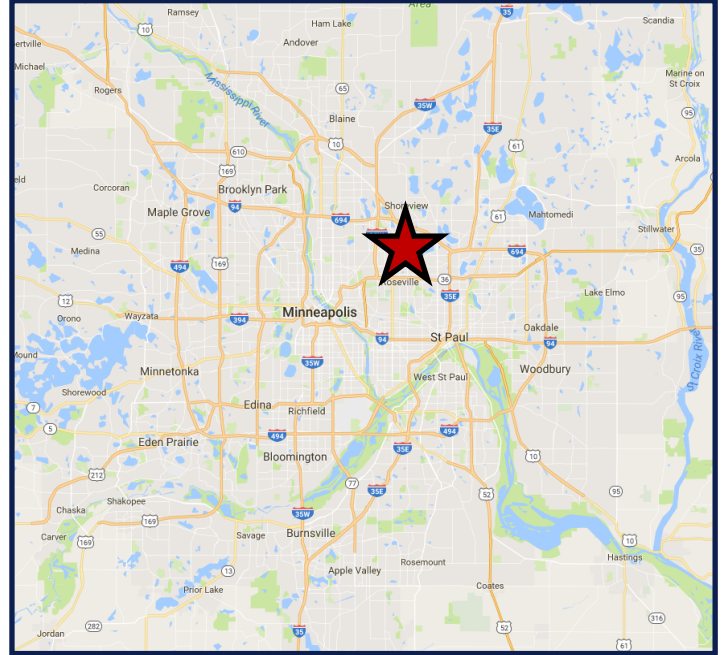

DEMOGRAPHICS

	1-MILE	3-MILE	5-MILE
POPULATION	9,058	65,806	218,178
DAYTIME POPULATION	5,771	68,234	142,819
MEDIAN HH INCOME	\$77,204	\$63,977	\$60,354
AVERAGE HH INCOME	\$102,527	\$89,675	\$85,193
MEDIAN AGE	47.1	42	38.2

TRAFFIC COUNTS

LEXINGTON AVE N	11,900 VPD
COUNTY ROAD D W	2,500 VPD

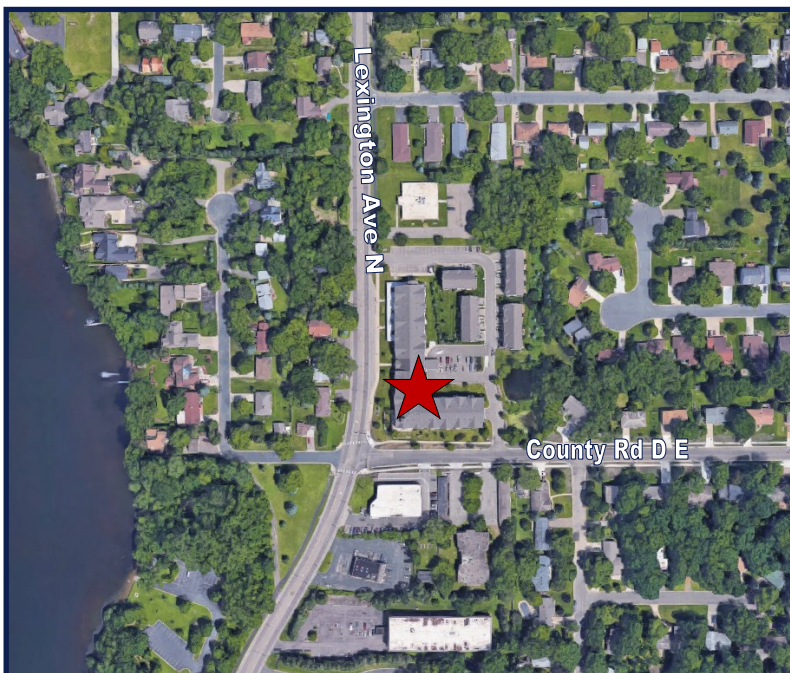

COMMENTS

- Private Covered patios available for commercial tenants.
- Ample street parking with a commercial designated lot.
- Beautiful mixed-use project with senior housing above and retail space on the street level.
- The property has an existing massage tenant.
- Conveniently located within walking distance to Lake Josephine.

THIS INFORMATION HAS BEEN SECURED FROM SOURCES WE BELIEVE TO BE RELIABLE, BUT WE MAKE NO REPRESENTATIONS OR WARRANTIES, EXPRESSED OR IMPLIED, AS TO THE ACCURACY OF THE INFORMATION. REFERENCES TO SQUARE FOOTAGE OR AGE ARE APPROXIMATE. UPLAND HAS NOT REVIEWED OR VERIFIED THIS INFORMATION. BUYER MUST VERIFY THE INFORMATION AND BEARS ALL RISK FOR ANY INACCURACIES.



THIS INFORMATION HAS BEEN SECURED FROM SOURCES WE BELIEVE TO BE RELIABLE, BUT WE MAKE NO REPRESENTATIONS OR WARRANTIES, EXPRESSED OR IMPLIED, AS TO THE ACCURACY OF THE INFORMATION. REFERENCES TO SQUARE FOOTAGE OR AGE ARE APPROXIMATE. UPLAND HAS NOT REVIEWED OR VERIFIED THIS INFORMATION. BUYER MUST VERIFY THE INFORMATION AND BEARS ALL RISK FOR ANY INACCURACIES.

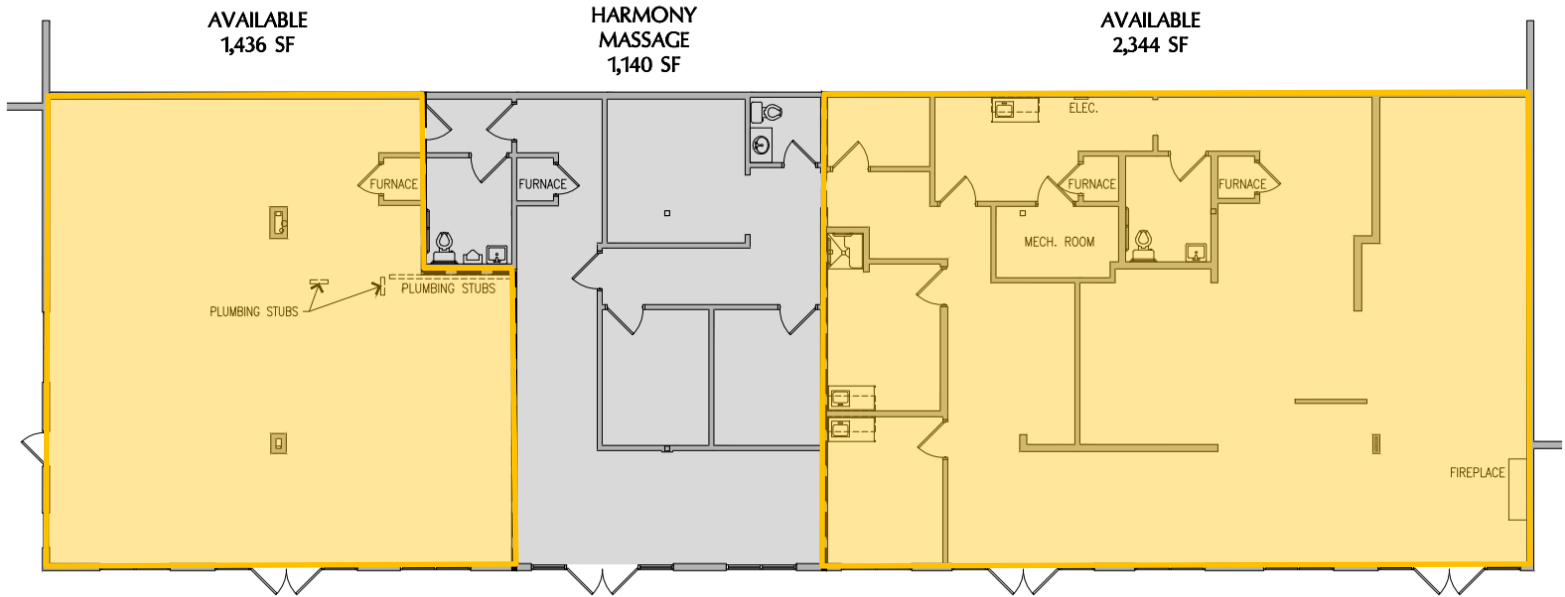

SITE PLAN



THIS INFORMATION HAS BEEN SECURED FROM SOURCES WE BELIEVE TO BE RELIABLE, BUT WE MAKE NO REPRESENTATIONS OR WARRANTIES, EXPRESSED OR IMPLIED, AS TO THE ACCURACY OF THE INFORMATION. REFERENCES TO SQUARE FOOTAGE OR AGE ARE APPROXIMATE. UPLAND HAS NOT REVIEWED OR VERIFIED THIS INFORMATION. BUYER MUST VERIFY THE INFORMATION AND BEARS ALL RISK FOR ANY INACCURACIES.

612.332.6600

THE SHORES | SHOREVIEW, MN | PAGE 5