



DOWNTOWN WESTMINSTER SITE PLAN



- 34,500 SF 1st Floor Retail
- 225 MF Units
- Food Hall
- OPENING Q1 2021

All information furnished regarding the property for sale or lease is obtained from sources deemed reliable. No representation is made as to the accuracy thereof and is submitted subject to errors, omissions, change of price, lease rates or other conditions, prior sale, lease or withdrawal without notice. The Laramie Company represents the Seller/Lessor in this transaction, and as such owes all duties and obligations thereto.



THE ASPIRE - DOWNTOWN WESTMINSTER



FOR LEASE GROUND FLOOR RETAIL / RESTAURANT SPACE

Location: The Aspire
89th Avenue and Westminister Blvd
Downtown Westminster, Colorado

Available: 2,500 SF - 20,000 SF of ground floor retail

- Project Highlights:**
- 225 Market Rate Apartment Units
 - Retail located on the ground floor of Aspire
 - Food Hall Opportunity
 - Key corner along Westminister Blvd in Downtown Westminster
 - Adjacent to Alamo Draffhouse Theater and Downtown Westminster Central Square

Downtown Westminster
At a Glance:

| | Phase 1 | Overall Downtown |
|-----------------------|----------|------------------|
| Developable Land | 10 Acres | 108 Acres |
| Residential Units | 600 | 2,500 |
| Retail Square Footage | 230,000 | 750,000 |
| Office Square Footage | 500,000 | 2,000,000 |

Contact: Bill Jenkins 303.573.1193 bill@laramiecompany.com
Andy Gray 303.573.4811 andy@laramiecompany.com





THE ASPIRE - RETAIL SPACE PLAN

WESTMINSTER BLVD.

FENTON STREET

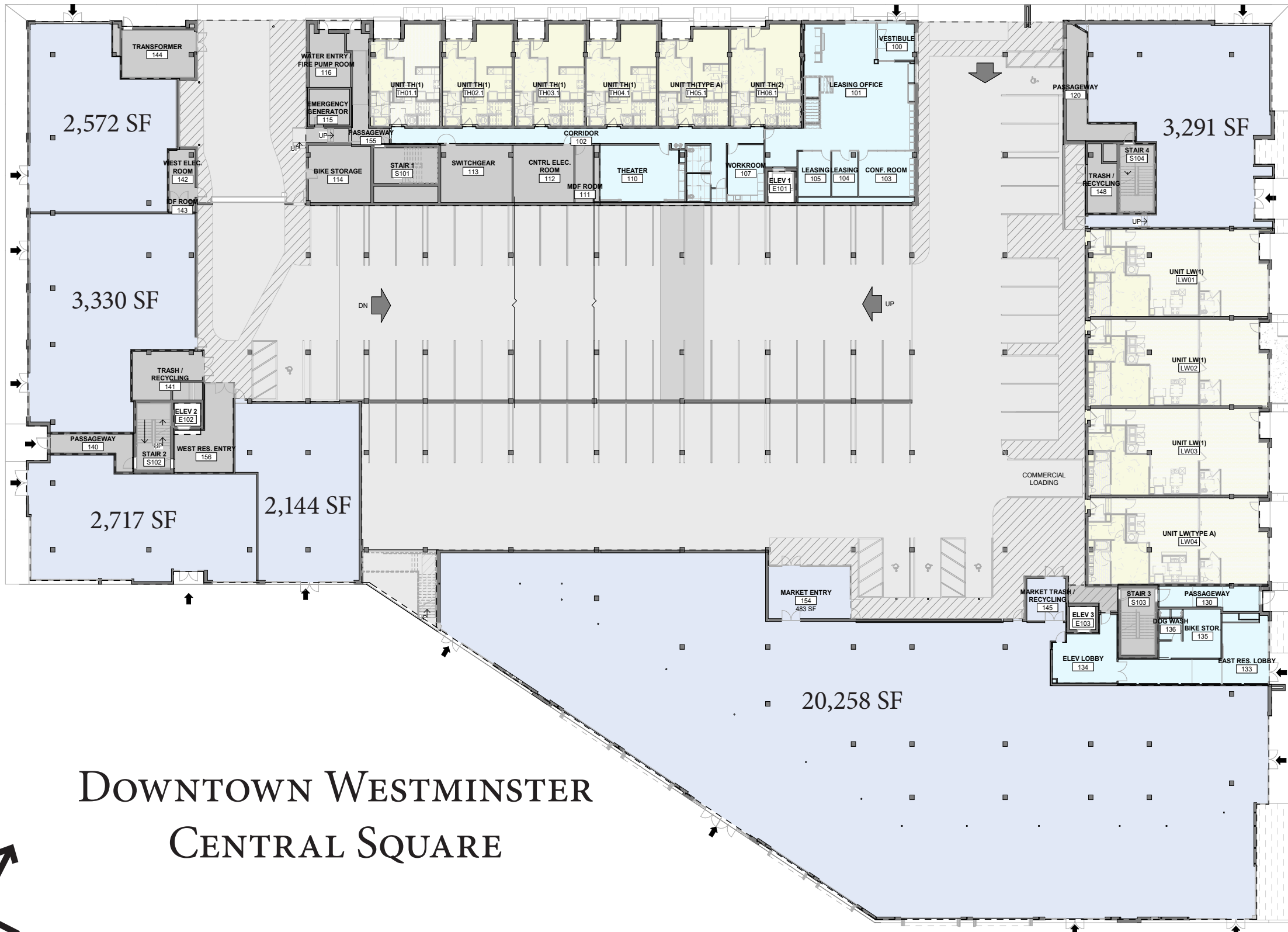

DOWNTOWN WESTMINSTER
CENTRAL SQUARE



KEY
 RESTAURANT / RETAIL SPACE